

Part # 00-026



Important! Installation of this product requires special tools.

Congratulations on your purchase of the "HPL" Hydraulic Preload Adjuster

These instructions are intended to provide the competent mechanic with the information necessary to understand the various functional aspects of the shock preload system and to correctly install and adjust this Merge product.

Product Background

A modern four stroke off-road motorcycle has the capability of adjusting the preload or pretension on the rear spring. Preload is the amount of tension applied to the spring when the shock absorber is at rest and fully extended. Rear Spring preload affects how high the rear of the bike rides when in motion.

- When the rear of the bike is too high it makes the bike feel unstable and "nervous"; it can also make the suspension react poorly on small bumps, especially entering corners.
- When the rear of the bike is too low it can make the bike steer poorly and feel "lazy", and reduce the amount of available rear wheel travel so the suspension is less able to absorb big jumps and holes, etc.

Adjusting the preload makes the full amount of rear wheel travel available, and is a key part of maintaining correct and important geometry, especially steering angles. With the HPL, setting up your bike for dry, wet or sandy conditions has never been so easy.

Installation

Important - If you are not a competent mechanic, do not attempt to install this product yourself; have your local dealer or suspension specialist install it for you. If you are not carrying out the work yourself, we recommend discussing the installation with the person who will perform the work, and make sure you preset the maximum race sag. - See section 1.

Precautions:

- **Always wear Safety Glasses when working on a motorcycle.**
- **Read all safety instructions in your manual.**
- **Always clean the area around the rear shock before disassembly.**

Before you install the HPL onto the shock we suggest you determine the base setting, as this reduces the possibility that you will need to readjust the threaded preload rings at a later stage.

1. Set the rear suspension race sag at the maximum that's recommended for your motorcycle. If your motorcycle only recommends a STD setting, then add 4 to 5mm – see examples below.
 - a. *Range Example: The owner's manual recommends 100 to 105 mm - set your race sag to 105mm.*
 - b. *Standard Setting Example: The owner's manual recommends 100 mm as a std setting. In this case adjust your race sag at 104 to 105mm.*

Important - Before you begin installation verify you have 20mm of exposed thread above the locking ring; if not, the HPL will not fit your model of motorcycle.

2. Remove rear shock per the owner's manual.
3. Unscrew the top lock ring until you have a gap of 20mm between the lock ring and the spring adjusting ring.
4. Remove the spring using suitable spring compressor.
5. Screw the spring adjusting ring up to and against the locking ring.
6. Install the HPL over the body and on to the spring adjuster ring being sure to locate the HPL in one of the spring adjusting ring notches.
7. Rotate the HPL as shown here.
8. Hold the locking ring and tighten the spring adjuster ring up to it with a suitable "C" wrench.
9. Reinstall the spring with a suitable spring compressor.
10. Reinstall the shock on to the motorcycle per your owner's manual.
11. Verify the HPL is not rubbing on any part of the chassis including the air boot; if so, loosen the spring locking ring and rotate the HPL until you have clearance, then retighten the lock ring.

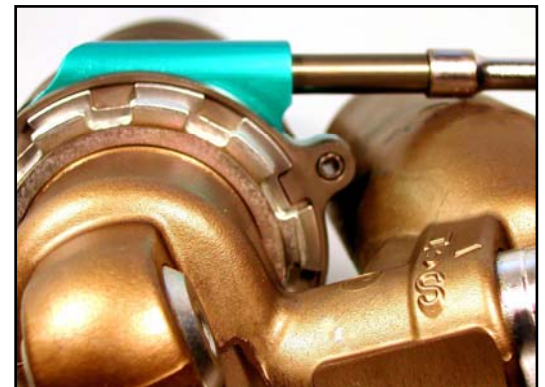

Adjustment and Setup

Adjust your race sag as recommended using an 8mm "T" handle. Rotating the HPL adjuster shaft clockwise will decrease race sag, rotating it counterclockwise will increase race sag. Note: This can be done while you are sitting on the bike.

Service and Maintenance

Service intervals depend upon many factors including spring rate and riding conditions. Merge recommends adjusting the race sag before you ride while your HPL is relatively clean. Note: The HPL does not need to be removed from the shock for normal service like seal replacement. Service kits which include full instructions for each model of HPL are available from your importer and/or mergeracing.com.

ITEM NO.	PART NUMBER	DESCRIPTION	QTY.
1	00-026-1	HPL, Outer Ring, KYB	1
2	00-026-2	HPL, Inner, KYB	1
3	00-023-3	HPL, Adj, Shaft	1
4	00-023-5	HPL, Guide Pin	1
5	00-023-4	HPL, Cap	1
6	00-026-7	HPL O-ring, Lwr. KYB	1
7	00-023-8	HPL O-ring, Adj.	1
8	00-023-9	HPL O-ring, Cap	1
9	00-023-7	HPL O-ring, Lwr	1

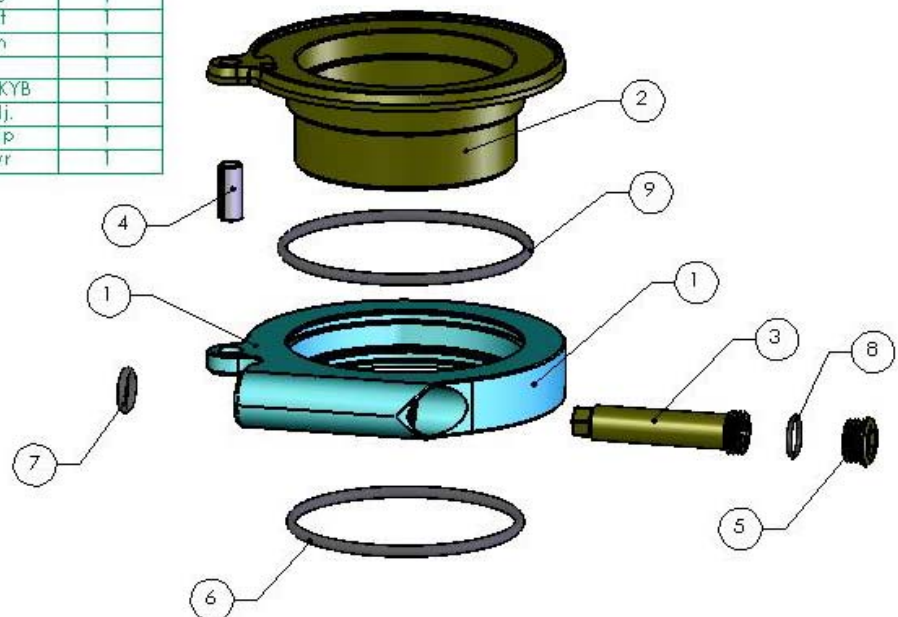

Additional items required

- Caliper
- Spring Adjuster “C” Wrench
- Tape Measure
- Owners manual for your motorcycle
- Spring compressor tool
-

Safety Notices –

- Offroad motorcycles should never be ridden when they are not functioning correctly.
- Always check nuts and bolts before riding

Disclaimer - Merge products are inspected prior to packaging. Our guarantee is limited to the replacement of defective products and/or components. This limited guarantee is in lieu of all other guarantees or warranties implied or expressed. Buyer assumes all risk for any and all damage caused to himself, a third party and/or property by virtue of failure of this product. We make no warranty as to products distributed by Merge Racing Technologies, expressed or implied from our suppliers or 3rd party vendors. This includes, without limitation, any warranties or merchantability and fitness for a particular purpose. All products are offered and designed for use with standard machines. Merge Racing Technologies makes no claims as to the products effectiveness on modified machines. Merge Racing Technologies is the sole determiner of abuse, misuse, installation errors and modifications. We assume no liability for any errors in listings, specifications, part numbers, prices or model applications. We reserve the right to change specifications, product descriptions, product quality, pricing and application at any time without notice and without further obligation. By installing and/or using a Merge Racing Technologies product, you hereby accept and understand these stated terms and conditions and have followed all instructional steps.

Other recommended Merge Racing Technologies products

- # 00-026K Rebuild Kit – KYB HPL
- # 00-008 “ALJ” Adjustable leak Jet
- # 00-019 “FMS” Fuel Mixture Screw
- # 00-018 “APS” Accelerator Pump Spring
- # 00-032/033 “RRS” Rising Rate Springs

Visit us on the web at www.mergeracing.com

Merge Racing Technologies, 3245 Main St, Suite #235-300, Frisco, TX 75034
support@mergeracing.com / sales@mergeracing.com